

Operating instructions

DFN 5/6

Range hood

Thank you for choosing to buy one of our products. Your appliance is made to high standards and is easy to use. Nevertheless, please take the time to read these operating instructions in order to familiarize yourself with the appliance and get the best use out of it.

Please follow the safety precautions.

Modifications

Text, diagrams and data correspond to the technical standard of the appliance at the time these operating instructions went to press. The right to make technical modifications for the purpose of the further development of the appliances is reserved.

Validity

The model number corresponds to the first alphanumeric on the identification plate. These operating instructions apply to:

Type	Product family	Size system
DFN5	61026	55
DFN6	61027	60

Variations depending on the model are noted in the text.

Inhaltsverzeichnis

1	Safety precautions	4
1.1	Symbols used.....	4
1.2	General safety precautions.....	4
1.3	Before using for the first time.....	4
1.4	Correct use	5
1.5	Note on use.....	5
2	Appliance description	7
2.1	Introduction	7
2.2	Extraction mode.....	7
2.3	Recirculation mode	7
2.4	Features.....	7
2.5	Construction	7
2.6	Operating elements.....	8
3	Operating the appliance	8
3.1	Switching the appliance on	8
3.2	Extractor fan	8
3.3	Illumination.....	9
3.4	Switching the appliance off.....	9
4	Care and maintenance	9
4.1	Cleaning the housing.....	9
4.2	Metal grease filters.....	10
4.3	Long-life activated charcoal filter	11
4.4	Standard activated charcoal filter.....	12
4.5	Replacing the LED light bulbs.....	13
5	Trouble-shooting	13
5.1	What to do if... ..	13
6	Accessories and spare parts	14
7	Technical data	14
7.1	Product fiche	14
8	Disposal	16
9	Index	17
10	Notes	18
11	Service & Support	19
	Quick instructions	20

1 Safety precautions

1.1 Symbols used



Denotes important safety precautions.

Failure to observe said precautions can result in injury or in damage to the appliance or fittings!



Information and precautions that should be observed.



Information on disposal



Information about the Operating Instructions

- ▶ Indicates step-by-step instructions.
 - Describes how the appliance reacts to the steps taken.
- Indicates a list.

1.2 General safety precautions



- Read the operating instructions before using the appliance for the first time.



- This appliance can be used by children aged 8 and above and by persons with reduced physical, sensory or mental capabilities, or lack of experience and/or knowledge, provided they are supervised or have been instructed on the safe use of the appliance and have understood the hazards involved. Children shall not play with the appliance.

Cleaning and user maintenance shall not be undertaken by children without supervision.

- If an appliance is not equipped with a mains cable and a plug or other means for disconnecting from the mains with a contact opening on each pole complying with the conditions of overvoltage category III for full isolation, an isolating device must be incorporated into the permanently installed electrical installation in accordance with the installation regulations.
- If the mains cable of this appliance is damaged, it must be replaced by the manufacturer or its Customer Services or a similarly qualified person in order to avoid hazard.

1.3 Before using for the first time

- The appliance must be installed and connected to the electricity supply in accordance with the separate installation instructions. Have a qualified fitter/electrician carry out the necessary work.
- Observe the official regulations for the exhaust-air layout.
- Dispose of the packaging material in accordance with local regulations.

1.4 Correct use

- The appliance is designed for use in the home for extracting cooking fumes and smells from above the cooking surface.
- Any repairs, modifications or manipulations to the appliance, especially any electrically live parts, may only be carried out by the manufacturer, its customer service department or similarly qualified persons. Repairs if carried out incorrectly may cause serious injury, damage to the appliance and fittings, as well as affect the functioning of the appliance. If the appliance is not working properly or in case a repair is needed, follow the instructions given in the 'Service & Support' section. Contact our Customer Services if necessary.
- Use original spare parts only.
- Retain these operating instructions for future reference.

1.5 Note on use

- If the appliance is visibly damaged, do not use it. Contact our Customer Services.
- If the appliance is not functioning properly, disconnect it from the power supply immediately.
- Ensure there is adequate ventilation when the extractor fan is on so as to avoid creating underpressure in the kitchen and to achieve optimal air extraction.
- Avoid a cross-current of air, which could blow the cooking vapours over the cooking area.
- If other appliances – fired by gas or other fuels – are being used at the same time, ensure that there is a sufficient supply of fresh air. This does not apply to air recirculation appliances.

- If other firing systems are being used at the same time (e.g. wood, gas, oil or coal fired heating appliances), safe operation is only possible providing a room negative pressure of 4 Pa (0.04 mbar) is not exceeded at the location of the appliance. Risk of toxic fumes! An adequate flow of fresh air must be guaranteed e.g. via non-closable openings in doors or windows and in combination with an air-intake/exhaust-air wall box or by other technical means.
- When cleaning the appliance make sure no water gets inside it. Use a moderately damp cloth only. Do not spray the inside or outside of the appliance with water. Do not use a steam cleaner. If water gets inside the appliance, it can cause damage.
- Accessible parts may become hot when used with cooking appliances.

Caution: Burns hazard!

- Do not leave the appliance unattended when deep-frying on the cooking surface. The cooking oil in the deep-frying appliance could overheat and catch fire. Constantly monitor the temperature of the cooking oil, keeping it below the temperature at which it can catch fire. Change the cooking oil regularly – dirty oil catches fire more easily than clean oil.

Caution: Risk to life!

- Packaging material, e.g. plastic film and polystyrene, can be dangerous for children and animals. Danger of suffocation! Keep packaging material away from children and animals.
- When carrying out maintenance work on the appliance, including replacing light bulbs, cut off the electricity supply to the appliance: remove the screw fuse from the holder or switch the circuit breaker off, or disconnect from the mains supply.

How to avoid damaging the appliance

- Observe the cleaning intervals. Failure to do so can increase the fire hazard due to the build-up of grease in the metal grease filters.

2 Appliance description

2.1 Introduction

The appliance is designed for use in the home for extracting cooking odours from above a cooking area and can be used in the extraction or recirculation mode.



Extraction mode



Recirculation mode

2.2 Extraction mode

A fan extracts cooking fumes and smells from above the cooking surface. The metal grease filters clean the extracted air, which is then passed through a connecting pipe fitted with an integrated non-return valve and through the air duct to the outside.



When in use, ensure there is a sufficient supply of fresh air to replace the air that is being extracted.

2.3 Recirculation mode

After being filtered through the metal grease filters, the cooking fumes and smells above the cooking area are passed through an activated charcoal filter. The filtered air is then circulated back into the room through the side openings.



If activated charcoal filters are not supplied with the appliance, these should be ordered and installed before using the appliance for the first time.

2.4 Features



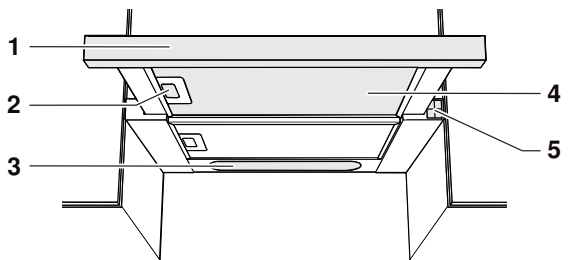

- Flat pull-out deflector plate
- Extractor fan with 3 power levels
- Operating elements
- LED lighting
- Metal grease filters
- Activated charcoal filter for recirculation mode (not included in the scope of delivery, available as an accessory)

2.5 Construction

- 1 Flat pull-out deflector plate
- 2 Grip
- 3 Illumination with cover
- 4 Metal grease filters
- 5 Operating elements



2.6 Operating elements

-  Switch extractor fan on/off
-  Power level 2
-  Power level 3
-  Switch illumination on/off

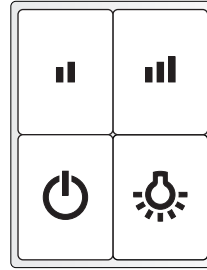

 Depending on the model and features, the specification of your appliance may differ in individual details from the standard specification described.

3 Operating the appliance

3.1 Switching the appliance on



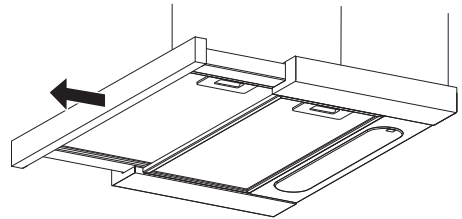

To switch the extractor fan on, the deflector plate must be pulled out.

- ▶ Pull the deflector plate out.





 The appliance is most effective when the deflector plate is fully pulled out.

3.2 Extractor fan

- ▶ Press the  button to switch the extractor fan on at power level 1.
- ▶ By also pressing the  button, level 2 is activated.
- ▶ By also pressing the  button, level 3 is activated.
- ▶ Press the  button repeatedly to switch the extractor fan off.

 We recommend switching the appliance on at level 2 some 5 minutes before starting to cook. Leave the appliance running for about 15 minutes after cooking to extract all the cooking smells.

3.3 Illumination

- ▶ Press the  button to switch the illumination on.
- ▶ Press the  button repeatedly to switch the illumination off.



The illumination does not switch off automatically when the deflector plate is pushed in.

3.4 Switching the appliance off

- ▶ Push the deflector plate completely in.
 - This switches off the extractor fan even if the  switch is on.

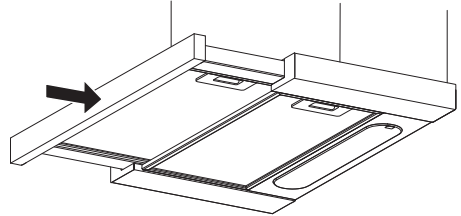

If the deflector plate is pulled slightly out again, the extractor fan comes on at the level previously set.

4 Care and maintenance

4.1 Cleaning the housing



Take care that no water gets into the housing of the appliance! If water gets into the housing, it can cause damage.

Do not use abrasive cleaners, scouring pads, steel wool, etc. for cleaning, as they can damage the surface. Disconnect the appliance from the mains and unscrew the fuse or switch off the automatic circuit breaker.

Cleaning the outside/inside

- ▶ Clean the outside of the appliance with a warm, damp cloth and a little detergent and then wipe dry.
 - Grease and condensate water can build up on the inside around the metal grease filters.
- ▶ Clean with a warm, damp cloth and a little detergent – you can also use a brush if necessary – and then wipe dry with a kitchen towel.

4.2 Metal grease filters

The metal grease filters must be cleaned at least once a month with normal use. If properly cared for, the grease filters should provide years of service.

Removing

 **Using both hands, carefully remove the metal grease filters, making sure not to drop or damage them.**

- ▶ Pull the deflector plate **1** completely out.
- ▶ Push the grip **2** on the grease filter in.
 - This releases the grease filter **3**.
- ▶ Carefully pull the grease filter **3** down and out of the fixture.
- ▶ Clean the grease filter **3**.

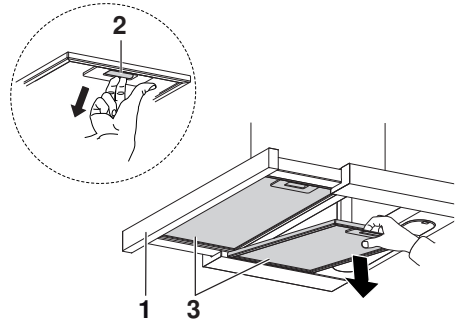

Cleaning

- ▶ Clean the grease filters **3** in the dishwasher.
- ▶ Select an «intensive» or «heavy» wash programme with a warm prewash.

 Cleaning may cause the metal grease filters to become slightly discoloured. However, this will not affect the functioning of the filters in any way.

If no dishwasher is available:

- ▶ Clean the grease filters **3** in the sink with hot water and detergent.
- ▶ Then soak the grease filters **3** in hot water in the sink for about 2 hours and finally clean with a washing-up brush. Rinse well with clean cold water.

Installing

- ▶ Reassemble in the reverse order.

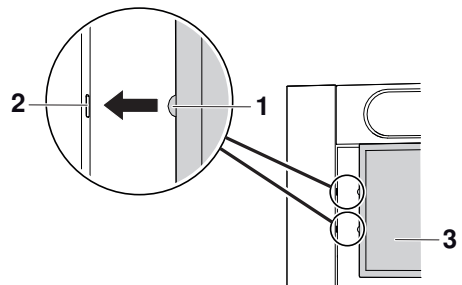

 Ensure all centring pins **1** are positioned properly in the receiving slots **2**.

4.3 Long-life activated charcoal filter

The long-life activated charcoal filter must be cleaned and reactivated bimonthly with normal use. If properly cared for, the service life of the long-life activated charcoal filter is 3 years.



Disconnect the appliance from the mains and unscrew the fuse for the appliance or switch off the circuit breaker.

Removing

- ▶ Pull the deflector plate completely out and remove both grease filters.
- ▶ Push bar **1** and move the activated charcoal filter unit **2** down and out of the bracket.
- ▶ Remove the activated charcoal filter mat **3** from its frame **4**.

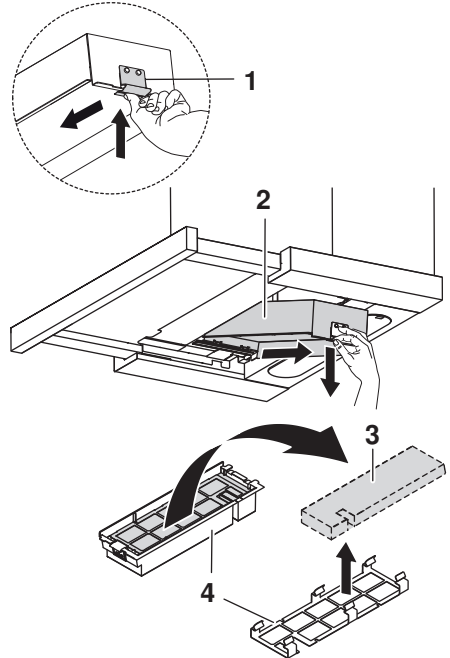

Cleaning and reactivating

- ▶ Clean the activated charcoal filter mat **3** in the dishwasher.
- ▶ Select an «intensive» or «heavy» dishwasher programme with a warm prewash. Wash separately so that no food debris can become stuck to the activated charcoal filter mat filter **3**.

If no dishwasher is available:

- ▶ Clean the activated charcoal filter mat **3** with hot water and detergent and then soak in hot water in the sink for an hour. Rinse well afterwards.
- ▶ To reactivate the activated charcoal, the activated charcoal filter mat **3** without the frame **4** must be dried in the oven.
- ▶ Select top/bottom heat or hot air and set the temperature to 100 °C. Place the activated charcoal filter mat **3** on the wire shelf and allow to dry for an hour.



The spent long-life activated charcoal filter can be disposed of in the household waste or at a suitable recycling point.

Installing

- ▶ Insert the activated charcoal filter mat **3** into the frame **4**.
- ▶ Insert the activated charcoal filter unit **2** into the bracket and press down firmly.
- ▶ Insert both grease filters again and close the deflector plate.
- ▶ Switch the fuse on.

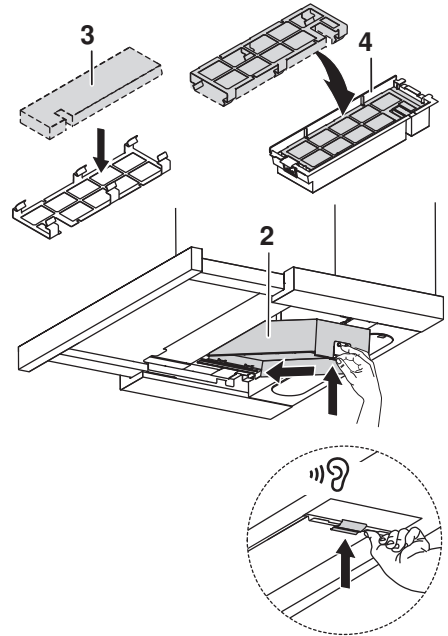

4.4 Standard activated charcoal filter

The standard activated charcoal filter is to be replaced after an operating time of 3 to 6 months. Standard activated charcoal filters cannot be washed or regenerated.

 **Disconnect the appliance from the mains and unscrew the fuse for the appliance or switch off the circuit breaker.**

Removing/Installing

- ▶ Pull the deflector plate completely out and remove both grease filters.
- ▶ Push bar **1** and move the activated charcoal filter unit **2** down and out of the bracket.
- ▶ Replace and dispose of the spent activated charcoal filter unit **3**.
- ▶ Reassemble in the reverse order.

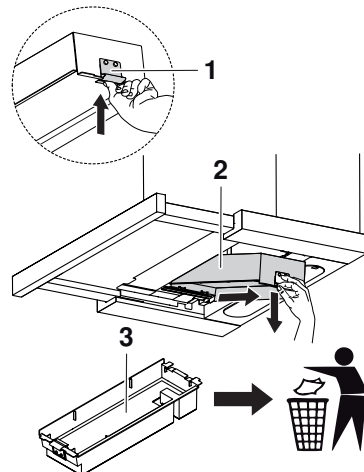



The spent standard activated charcoal filter can be disposed of in the household waste or at a suitable recycling point.

4.5 Replacing the LED light bulbs



Disconnect the appliance from the mains and disengage the fuse or automatic circuit breaker.

Removing/Installing

- ▶ Remove both grease filters.
 - The light cover can be accessed from the back.
- ▶ Replace the light bulb with a new light bulb of the same type (see designation on the light bulb housing or on the identification plate).
- ▶ Insert the grease filters and engage the fuse or automatic circuit breaker.

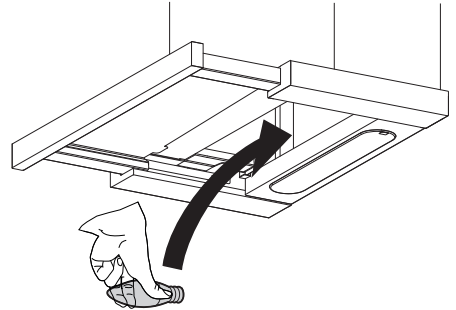

5 Trouble-shooting

5.1 What to do if...

... the illumination is not working

Possible cause	Solution
<ul style="list-style-type: none"> ▪ Fuse or automatic circuit breaker for electrical installations in the home is defective. 	<ul style="list-style-type: none"> ▶ Replace the fuse. ▶ Reset the automatic circuit breaker.
<ul style="list-style-type: none"> ▪ An interruption in the power supply. 	<ul style="list-style-type: none"> ▶ Check the power supply.
<ul style="list-style-type: none"> ▪ LED light bulb is defective. 	<ul style="list-style-type: none"> ▶ Change the LED light bulb

... the appliance is not extracting enough air

Possible cause	Solution
<ul style="list-style-type: none"> ▪ The metal grease filters are dirty. 	<ul style="list-style-type: none"> ▶ Clean the metal grease filters.
<ul style="list-style-type: none"> ▪ Only for recirculation mode: The activated charcoal filters are saturated. 	<ul style="list-style-type: none"> ▶ Clean and reactivate or replace the activated charcoal filters.
<ul style="list-style-type: none"> ▪ Only for extraction mode: The fresh air intake is insufficient. 	<ul style="list-style-type: none"> ▶ Ensure the fresh air intake is sufficient.

6 Accessories and spare parts

Please give model number of the appliance and exact designation of the accessory or spare part when ordering parts.

LED light bulb (E14)

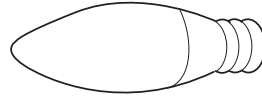

Metal grease filters

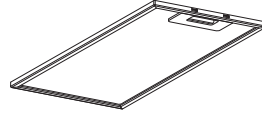

Long-life activated charcoal filter

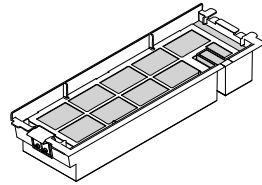

Standard activated charcoal filter

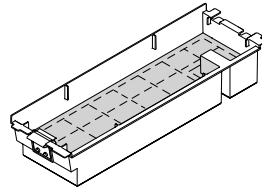

7 Technical data

Electrical connection

- ▶ See identification plate.
 - ▶ Remove the metal grease filters.
 - The identification plate is located on the inside of the appliance.

7.1 Product fiche

In accordance with EU Regulation No. 65/2014 and No. 66/2014.

Description	Abbreviations	Unit	Value
Brand	S	-	V-ZUG Ltd
Model identifier	M	-	61026 / 61027
Annual Energy Consumption	AEC _{hood}	kWh/a	39.7
Energy Efficiency Index	EEl _{hood}	%	46.6

Energy Efficiency Class	EEC	-	A
Fluid Dynamic Efficiency	FDE_{hood}	%	33.5
Fluid Dynamic Efficiency Class	FDEC	-	A
Lighting Efficiency	LE_{hood}	lux/W	9.0
Lighting Efficiency Class	LEC	-	E
Grease Filtering Efficiency	GFE_{hood}	%	66.0
Grease Filtering Efficiency Class	GFEC	-	D
Air flow at minimum speed	Q_{min}	m ³ /h	256.0
Air flow at maximum speed (intensive or boost excluded)	Q_{max}	m ³ /h	647.0
Air flow at intensive or boost setting	Q_{boost}	m ³ /h	-
Airborne acoustical A-weighted Sound Power Emissions at minimum speed	SPE_{min}	dBA	46.0
Airborne acoustical A-weighted Sound Power Emissions at maximum speed	SPE_{max}	dBA	67.0
Airborne acoustical A-weighted Sound Power Emissions at intensive or boost setting	SPE_{boost}	dBA	-
Measured power consumption of off mode	P_0	W	-
Measured power consumption of standby mode	P_s	W	-
Time increase factor	f	-	0.8
Measured air flow rate at the best efficiency point	Q_{BEP}	m ³ /h	336.0
Measured air pressure at the best efficiency point	P_{BEP}	PA	434.0
Measured value of the electric power input at the best efficiency point	W_{BEP}	W	121.0
Nominal power of the lighting system	W_L	W	6.0
Average illumination of the lighting system over the cooking surface	E_{middle}	lux	54.0
Sound power level	L_{wa}	dBA	67.0

8 Disposal

8.1 Packaging



Never allow children to play with packaging material due to the danger of injury or suffocation. Store the packaging material in a safe location or dispose of it in an environmentally-friendly way.

8.2 Safety

Render the appliance unusable to prevent accidents caused by improper use (e.g. through children playing):

- ▶ Disconnect the appliance from the mains. With a fixed appliance, this is to be carried out by a qualified electrician. Then cut the mains cable off flush with the appliance.

8.3 Disposal



-  The «crossed out wheeled bin» symbol requires the separate collection of waste electrical and electronic equipment (WEEE). Such equipment can contain hazardous, environmentally harmful materials.
- These appliances are to be handed over to a designated collection point for the recycling of electrical and electronic equipment and must not be disposed of with unsorted household waste. And in this way, you will be helping to protect resources and the environment.
- For more information, please contact the local authorities.

9 Index

A	
Accessories	14
Appliance description	7
Appliance disposal	16
C	
Care and maintenance	9
Cleaning	
Activated charcoal filter	11
Housing	9
Metal grease filters	10
Construction	7
D	
Disposal	16
E	
Electrical connection	14
Equipment	7
Extraction mode	7
I	
Identification plate	14
Illumination	9
Initial set-up	4
M	
Model designation	2
Model number	2
N	
Notes	18
O	
Operating elements	8, 20
P	
Product fiche	15
Q	
Queries	19
R	
Recirculation mode	7
Replacing light bulb	13
S	
Safety precautions	
Before using for the first time	4
Correct use	5
Note on use	5
Safety warnings	
General	4
Service & Support	19
Service agreement	19
Switching off	9
Switching on	8
Symbols	4
T	
Technical data	14
Type	2
V	
Validity	2
W	
What to do if	
the appliance is not extracting enough air	
.....	13
the illumination is not working	13

10 Notes

11 Service & Support



The «Trouble-shooting» section gives you valuable tips on how to deal with minor malfunctions yourself, saving you the time and trouble of calling out a service technician and any cost that goes along with it.

Information on the V-ZUG warranty can be found at www.vzug.com →Service →Warranty information. Please read this information carefully.

Please register your V-ZUG appliance straightaway:

- online at www.vzug.com →Service →Online warranty registration or
- using the enclosed registration card.

This will allow you to take advantage of the best possible support in the event of a fault in the appliance during the guarantee period. You will require the serial number (SN) and appliance designation to register your appliance. You will find them on the identification plate of your appliance.

My appliance information:

SN: _____ **Appliance:** _____

Please have this appliance information to hand when contacting V-ZUG. Thank you.

- ▶ Remove the metal grease filters.
 - The identification plate is located on the inside of the appliance.
 - A second identification plate is included in the scope of delivery and should be retained for the purpose of appliance identification.





Your repair order

Call the free service number 0800 850 850 to contact your nearest V-ZUG service centre. You can arrange an on-site visit by us by phone if you wish.

General queries, accessories and service agreement

V-ZUG will be happy to help you with any general administrative or technical queries, to accept your orders for accessories and spare parts and to inform you about our progressive service agreements. You can contact us by calling tel. +41 58 767 67 67 or by going to our website at www.vzug.com.

Quick instructions

-  Switch extractor fan on/off
-  Power level 2
-  Power level 3
-  Switch illumination on/off

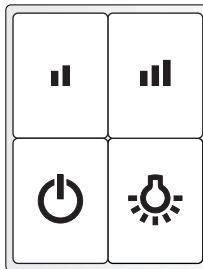

1020575-R02